

# Office/Warehouse Space for Lease

# Loveland



## FEATURES

- 2,700 SF Office/Warehouse Available
- 2,700 SF Office Available
- 540+/- SF Storage Room with Garage Door Available (Air Conditioned)
- 100% Air Conditioned
- Attractive modern building
- New parking lot
- New Roof - March 2024
- New access road
- Seconds from I-275
- **No Earnings Tax!**

## LOCATION

**394 Wards Corner Road  
Suites 130 & 140  
Loveland, OH 45140**

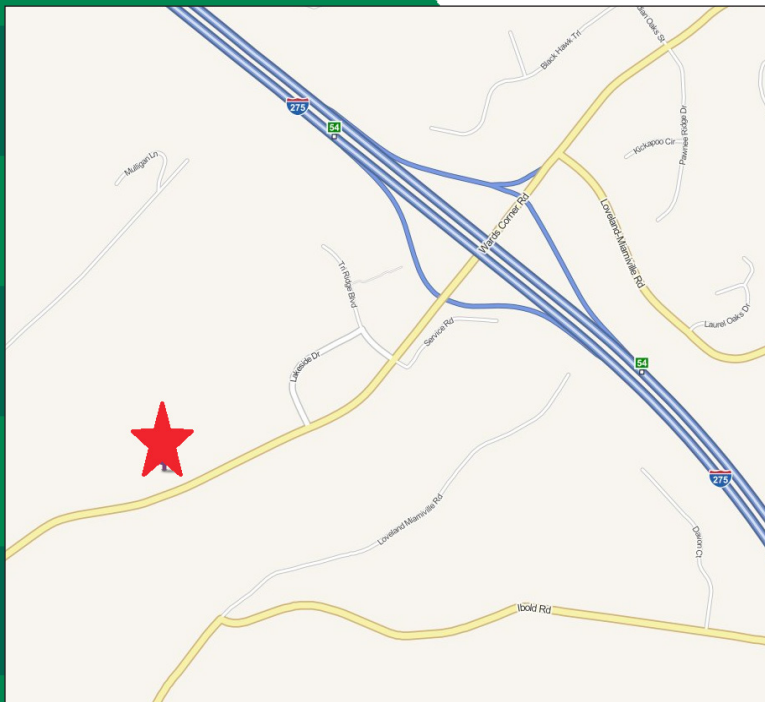

## CONTACT

**Frank Torbeck, SIOR**

frank.torbeck@everestrealstate.com

513/769-2505

The information submitted is not guaranteed. Although obtained from reliable sources, it is subject to errors, omissions, prior sale and withdrawal from the market without notice.

**EVEREST**

**COMMERCIAL REAL ESTATE SERVICES**

WEB [www.everestrealstate.com](http://www.everestrealstate.com) TEL 513-769-2500 FAX 513-769-2512

9902 Carver Road, Sycamore Office Park, Suite 105, Cincinnati, Ohio 45242

# 394 Wards Corner Rd.

<b>Address/City/County:</b>	394 Wards Corner Road Loveland/Miami Twp./Clermont Cty.
<b>Building Size:</b>	27,000 SF Total
<b>Available Suites:</b>	Suite 130 - 2,700 SF 1,565+/- SF office - (4) private offices 1,135+/- SF warehouse (2) Restrooms (1) 10' x 8' Dock (glassed in)  Suite 140 - 2,700 SF Office Space (6) fully furnished private offices (2) conference rooms (one is shared with unit 150)  Storage Room - Rear of Suite 150 540 SF Storage Room with Garage Door (Air Conditioned)
<b>Land Size:</b>	2.33 acres
<b>Date of Construction:</b>	1988
<b>Type of Construction:</b>	Frame and brick facade
<b>Zoning:</b>	Light Industrial
<b>Clearance Height:</b>	14'
<b>Dock Door:</b>	Dock opening glassed in
<b>Lighting:</b>	LED Lighting
<b>Parking:</b>	3/1,000 SF
<b>Electric:</b>	Single & three phase
<b>Roof:</b>	New Membrane Roof
<b>Heat &amp; A/C:</b>	Forced air with AC (office & warehouse); gas units (warehouse)
<b>Lease Rate:</b>	\$10.00 PSF + \$4.20 PSF Operating Expenses



[www.everestrealstate.com](http://www.everestrealstate.com)

TEL 513-769-2500

FAX 513-769-2512

9902 Carver Road

Sycamore Office Park

Suite 105

Cincinnati, Ohio 45242

FOR MORE INFORMATION, CONTACT

**Frank Torbeck, SIOR**

[frank.torbeck@everestrealstate.com](mailto:frank.torbeck@everestrealstate.com)

513/769-2505